



EN/ASSEMBLY INSTRUCTIONS

A.D.P. 200

MARKET SEGMENTS



CONSTRUCTION



AGRICULTURE/
FORESTRY



RV



PUBLIC SAFETY



UTILITY/CARGO



PERSONAL
TRANSPORT



AMBULANCE

1 PRIOR INFORMATION

1.1	Instructions for use	4
1.1.1	Intended Use	4
1.1.2	Unauthorised use	4
1.2	Installation instructions	4
1.3	Legal regulation	4
1.4	Type approval	5
1.5	CE declaration of conformity	5
1.6	UKCA declaration of conformity	5
1.7	Cleaning and maintenance instructions	5
1.8	Note on environmental protection	5
1.9	Technical support	5

2 LIST OF EQUIPMENT CONCERNED

3 PRODUCT INFORMATION

3.1	Overview	6
3.2	Technical data	6
3.3	Main Dimensions	6
3.4	Installation	6
3.5	Installation position	7
3.6	Electrical connection	7

4 MAINTENANCE

5 REPAIR

6 CE DECLARATION OF CONFORMITY

7 UKCA DECLARATION OF CONFORMITY

Refer to the safety information sheet supplied with the product, and to the risks and preventive measures indicated in the form of pictograms.

1 Prior information

1.1 Instructions for use

This document contains information necessary to operate your equipment.
Please print and keep this documentation in a safe place for future reference.

1.1.1 Intended Use

Eberspächer Kalori equipment is designed to ventilate, heat and/or cool passenger compartments and cabins, or to de-ice the windscreen and windows of the vehicle.

The equipment is intended for professional use in L, M, N, O, T, C, R and S vehicles and in machines such as construction engineering machines, forestry machines, handling machines, tower cranes, mining machines or airport vehicles.

For all other professional uses, the installation must be carried out by a professional installer, who verifies that the equipment corresponds to the application.

1.1.2 Unauthorised use

Modifications to the equipment are strictly prohibited. Any unintended use and any other use of the equipment beyond or different from the intended use is considered to be misuse. The warranty becomes null and void and Eberspächer Kalori is no longer liable.

This product is not intended for domestic use.

Eberspächer Kalori equipment is not intended for the following applications:

- Long-term operation, for example for air conditioning or heating in homes, garages or containers

1.2 Installation instructions

Failure to comply with the warnings and safety instructions invalidates the warranty and means that Eberspächer Kalori cannot be held liable.

The equipment must not be installed and used:

- in extremely dusty environments
- in an aggressive environment
- in the event of excessive vibrations of the machine or the vehicle
- in a way that does not comply with the regulations in force
- without full or partial compliance with the operating or assembly instructions
- without maintenance and/or use of original spare parts

- in such a way as to damage its environment
- so as not to be damaged by the environment.

The equipment should only be installed in the position indicated in the instruction manual.

The installation of this equipment in the vehicle or machine must ensure that it is protected against reasonably foreseeable impacts (e.g. kicking, etc.).

The installation, use and maintenance of the equipment must comply with the regulations in force in the country of use.

This equipment cannot be operated alone and must be supplemented by other components such as a diffuser, a control panel.

The equipment should be stored in a dry place.

Electrical parts that are not sealed must be protected against water and dust.

Ensure that all electrical components involved in the installation of the equipment are correctly sized.

Complete the electrical connections necessary for the wiring of the equipment, carefully following the instructions in the manual. Provide electrical protection upstream of the equipment.

Electrical protections (disconnecting device, fuses) are not supplied with the equipment.

Power cables upstream of the equipment should be clamped.

For wall vents > 60VDC:

Dual voltage equipment must be powered by 2 different power sources. The 12Vdc and 24Vdc products must be powered by batteries.

Equipotential bonding cables with a cross-section of less than 4 mm² must be mechanically protected during product integration.

1.3 Legal regulation

Legal regulations are mandatory and must also be complied with in countries where there are no special regulations.

The manufacturer follows a policy of continuous development and, in this respect, reserves the right to make changes and improvements to the documentation and equipment without prior notice.

Compliance with legal provisions and all instructions and instructions contained in this document, as well as with the safety information supplied with the product, is a prerequisite to any warranty and liability claim.

Repairs by unauthorized third parties and/or with non-original spare parts are not permitted. This will result in the expiration of

the equipment approval and may result in the expiration of the vehicle or machine operating license.

1.4 Type approval

For some components, the Centre National de Réception des Véhicules (National Vehicle Approval Centre) has issued a type approval according to ECE-R10 for installation in motor vehicles, with an official type approval marking noted on the component's nameplate.

Eberspaecher Kalori products may only be used in vehicles that are fully approved by the customer.

1.5 CE declaration of conformity

We hereby declare that the version of the product we are placing on the market complies with the applicable provisions of the following European directives:

- CEM Directive 2014/30/EU



- Machinery Directive 2006/42/CE

1.6 UKCA declaration of conformity

We hereby declare that the version of the product we are placing on the market complies with the applicable provisions of the following UKCA directives:

- The Electromagnetic Compatibility Regulations 2016
- The Supply of Machinery (Safety) Regulations 2008



1.7 Cleaning and maintenance instructions

Wash with a damp cloth.

1.8 Note on environmental protection



WEEE Directive 2012/19/EU

Electrical and electronic devices should not be disposed of with household waste. Consumers are required by law to return electrical and electronic equipment at the end of its life to the public collection points provided for this purpose or to the point of sale. The details of this obligation are defined by the national legislation of the country concerned. The symbol on the product, the instruction manual or the packaging indicates that a product is subject to these regulations.

1.9 Technical support

If you have any technical questions or problems with the equipment, please contact your dealer.

2 List of equipment concerned

If your equipment is not described in the table below, please contact your dealer for specific documentation.

The attached installation manual is for the following part numbers:

Part number	Description
8300 12150001	AERATEUR ADP 200 12V
8300 12150100	AERATEUR ADP 200 24V

3 Product information

3.1 Overview

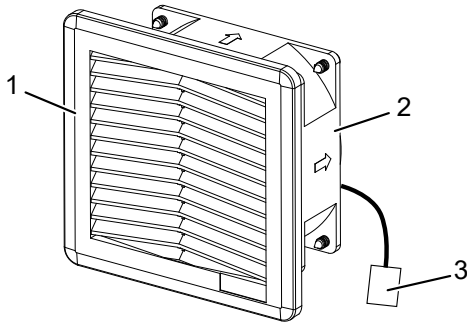

No	Description
1	Face
2	Fan
3	Connector

3.2 Technical data

MODEL	A.D.P. 200	
Part number	8300 12150001	8300 12150100
Rated voltage (+/-10%)	12V	
Air flow	200m ³ /hr - 118 CFM	
Max. Fan consumption ⁽¹⁾	10W	
Operating temperature range	-20 / +40°C [-4 / +104°F]	
Storage temperature range	-30 / +70°C [-22 / +158°F]	
Fuse ⁽²⁾	2A	2A
Weight	0.43 kg - 0.95 lb	

(1) Inrush current can vary from 1 to 10 times the rated current of the product depending on integration and operating conditions. To be checked on the vehicle.

(2) Must be checked following vehicle installation.

Use of the equipment outside the specified technical data may result in malfunctions.

The technical data must be observed at all times.

3.3 Main Dimensions

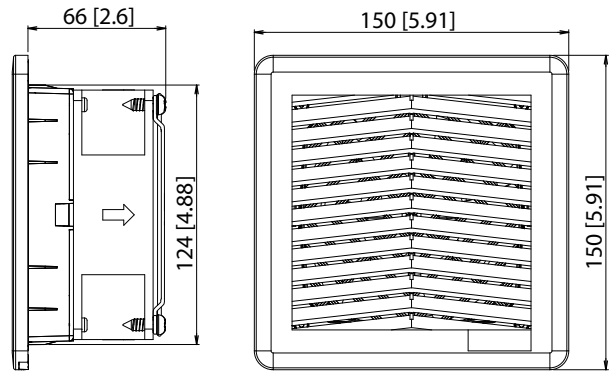

3.4 Installation

Installation equipment is not included in the scope of supply.

Mounting accessories can be ordered separately.

Provide sufficient intake area so as not to impair the equipment's airflow.

Split the location

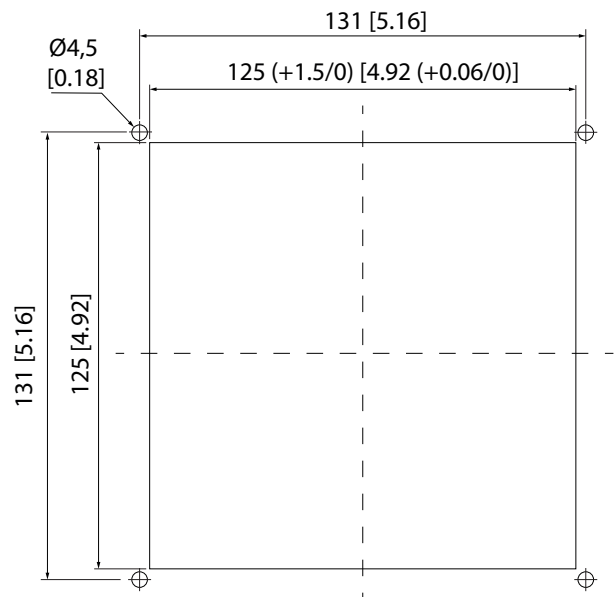

3.5 Installation position

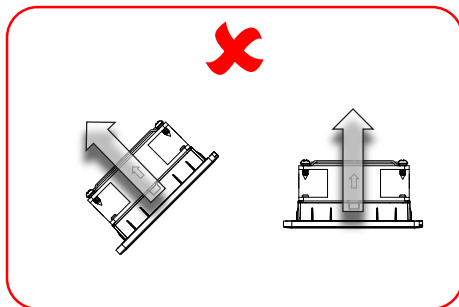
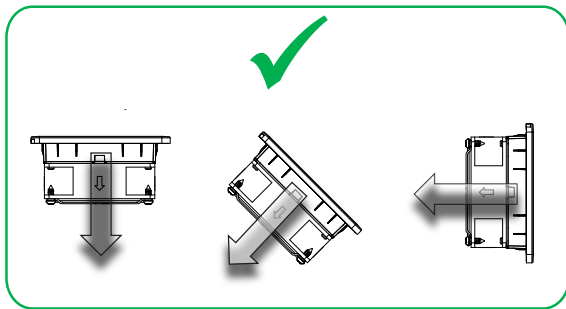

 : direction of air flow.

3.6 Electrical connection

Blower

The equipment is supplied with bare wires.
Before installation, an electrical connector must be installed on the equipment.

Cable meaning:

- Orange wire: Low fan speed.
- Red wire: High fan speed.
- Black wire: Ground.

4 Maintenance

The following maintenance checklist should be carried out by qualified personnel. The frequencies indicated are indicative and must be adapted according to the environment.

Contact your dealer in case of a failure detected during maintenance.

Every month

	ADP
Clean and/or replace the air filter(s)	●

Every six months

	ADP
Check that the fan(s) is (are) still able to operate.	●
Check the tightness of the various screws and fittings.	●
Check for corrosion of metal parts, housings, screws and inserts. Change these parts if necessary.	●
Check the integrity/tightness of all electrical parts: power cables, ground cable, grommets, connectors, lugs, fan, motor resistor, protective equipment such as fan thermal fuses, etc. (non-exhaustive list).	●

5 Repair

Malfunction	Possible cause	Solution	ADP
Poor ventilation	Blowing out clogged air	Check air diffusion for dirt and clean if necessary	●
	Fan off	Check the electrical connections and replace if necessary	●
		Check the fuse and replace if necessary	●
	End of life of the fan	Contact your dealer, see the spare parts list for the part number to order	●
	Faulty instrumentation and control	Check the instrumentation and control and replace if necessary	●
Abnormal noise and/or vibration	Faulty power supply	Check the fuse and replace if necessary	●
		Turn off the equipment and contact your dealer	●

6 CE declaration of conformity



Pusignan, 29/11/22

PART NUMBER 8300 40130074 OC / EN / 11.2022

CE declaration of conformity

The products of the family ADP

- are compliant with the directive CEM 2014/30/UE :
EN 61000-6-3, EN61000-6-1
- comply with the machine directive 2006/42/CE :
 - EN 60204-1 Septembre 2018 paragraphs 4.1, 4.2.1, 4.3, 4.4.1, 4.4.2, 4.4.3, 4.4.4, 4.4.5, 4.5, 4.6,6.1, 6.2, 6.3,7.1, 7.2.1, 7.2.3, 7.2.4, 7.2.8, 7.3.1, 7.4, 7.5, 7.6, 7.7,8.1, 8.2,12.1, 12.2, 12.3, 12.4, 12.6,13.1.3, 13.2.1, 13.2.2, 13.2.3, 13.5.1,14.1, 14.2,14.3,16, 17, 18

The products are delivered with A CE marking for this purpose.

Technical Manager: Stéphanie LE FAUCHEUR - Engineering manager

BONTEMPS Olivier
General Manager

Eberspächer Kalori
ZI de Mariage - Voie E
69330 Pusignan
Phone +33 4 72931010
Fax +33 4 72931019
www.eberspaecher-kalori.com

Eberspächer Kalori S.A.S. au capital de 350 015€
SIRET 443 021 522 00018
APE 2932Z No intracommunautaire FR66 443 021 522
RCS LYON 443 021 522

7 UKCA declaration of conformity



Pusignan, 29/11/22

PART NUMBER 8300 40135072 OC / EN / 11.2022

UKCA declaration of conformity

The products of the family ADP

- are compliant with the directive "Electromagnetic Compatibility Regulations 2016" :
EN 61000-6-3, EN61000-6-1
- comply with the machine directive "Supply of Machinery (Safety) Regulations 2008" :
 - EN 60204-1 Septembre 2018 paragraphs 4.1, 4.2.1, 4.3, 4.4.1, 4.4.2, 4.4.3, 4.4.4, 4.4.5, 4.5, 4.6, 6.1, 6.2, 6.3, 7.1, 7.2.1, 7.2.3, 7.2.4, 7.2.8, 7.3.1, 7.4, 7.5, 7.6, 7.7, 8.1, 8.2, 12.1, 12.2, 12.3, 12.4, 12.6, 13.1.3, 13.2.1, 13.2.2, 13.2.3, 13.5.1, 14.1, 14.2, 14.3, 16, 17, 18

The products are delivered with A UKCA marking for this purpose.

Technical Manager: Stéphanie LE FAUCHEUR - Engineering manager

BONTEMPS Olivier
General Manager

Eberspächer Kalori
ZI de Mariage - Voie E
69330 Pusignan
Phone +33 4 72931010
Fax +33 4 72931019
www.eberspaecher-kalori.com

Eberspächer Kalori S.A.S. au capital de 350 015€
SIRET 443 021 522 00018
APE 2932Z No intracommunautaire FR66 443 021 522
RCS LYON 443 021 522

